

OPPERVLAKTES	
Appartement	73.76m <sup>2</sup>
Terras	21.21m <sup>2</sup>
Kelder	3.43m <sup>2</sup>
Parking	19.43m <sup>2</sup>
TOTAAL	117.83m <sup>2</sup>

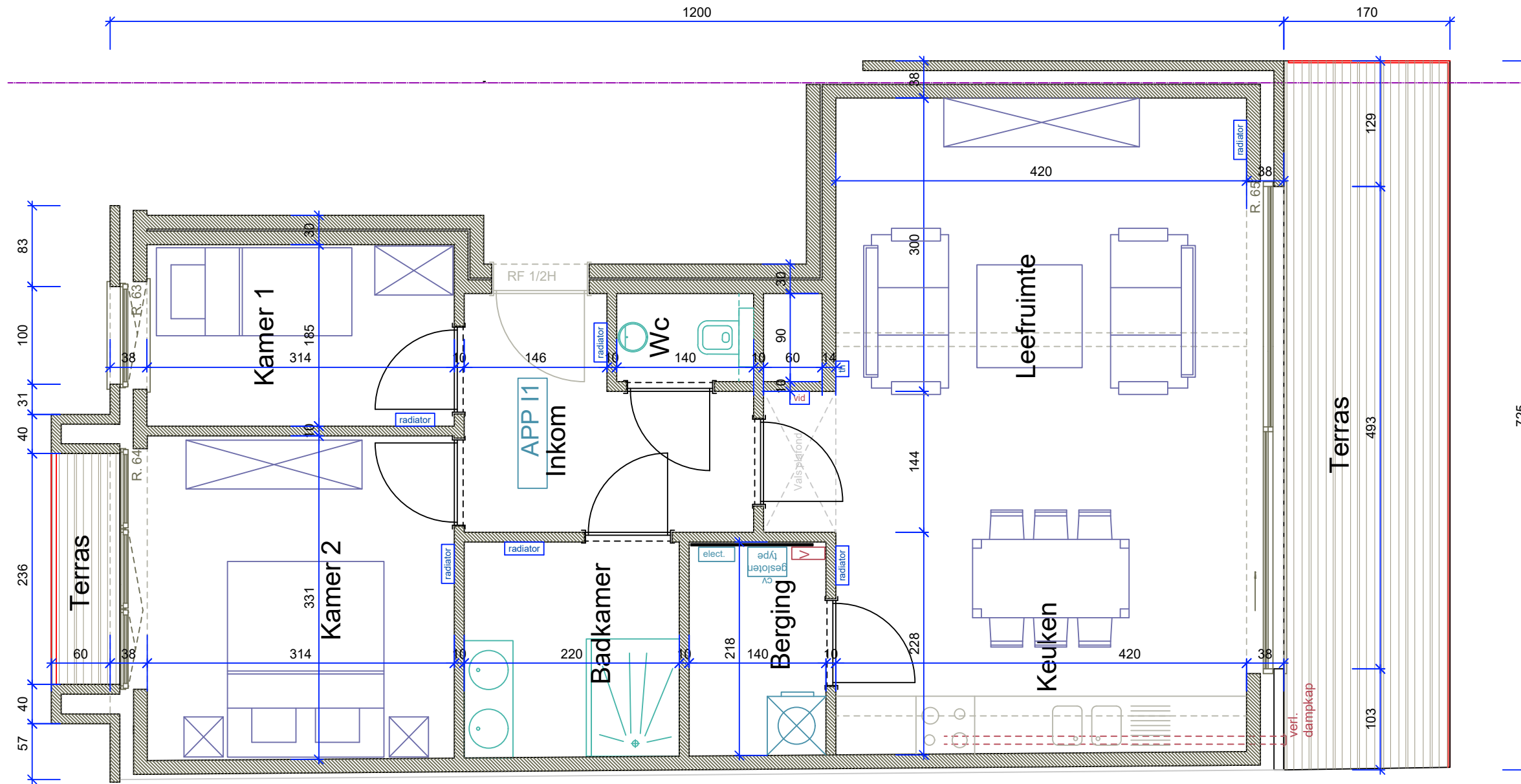

<b>RESIDENTIE VIK</b>	App. I1 - Kelder nr 16 - Parking nr 25 Hoek Brusselsesteenweg / Hofkwartier Meerbeke 9402	
	DATUM: 09/08/2017	FORMAAT A3 - SCHAAL 1:50
		PLAN NR 1/1

**TRAWOBO  
INVEST**

Gregory:  
0499 36 17 83

Shana:  
0472 76 10 41

EDGARD TINELSTRAAT 18 BUS 1 - SINT-LIEVENS-HOUTEM <http://www.trawobo-invest.be> [info@trawobo-invest.be](mailto:info@trawobo-invest.be)